

Concept 3

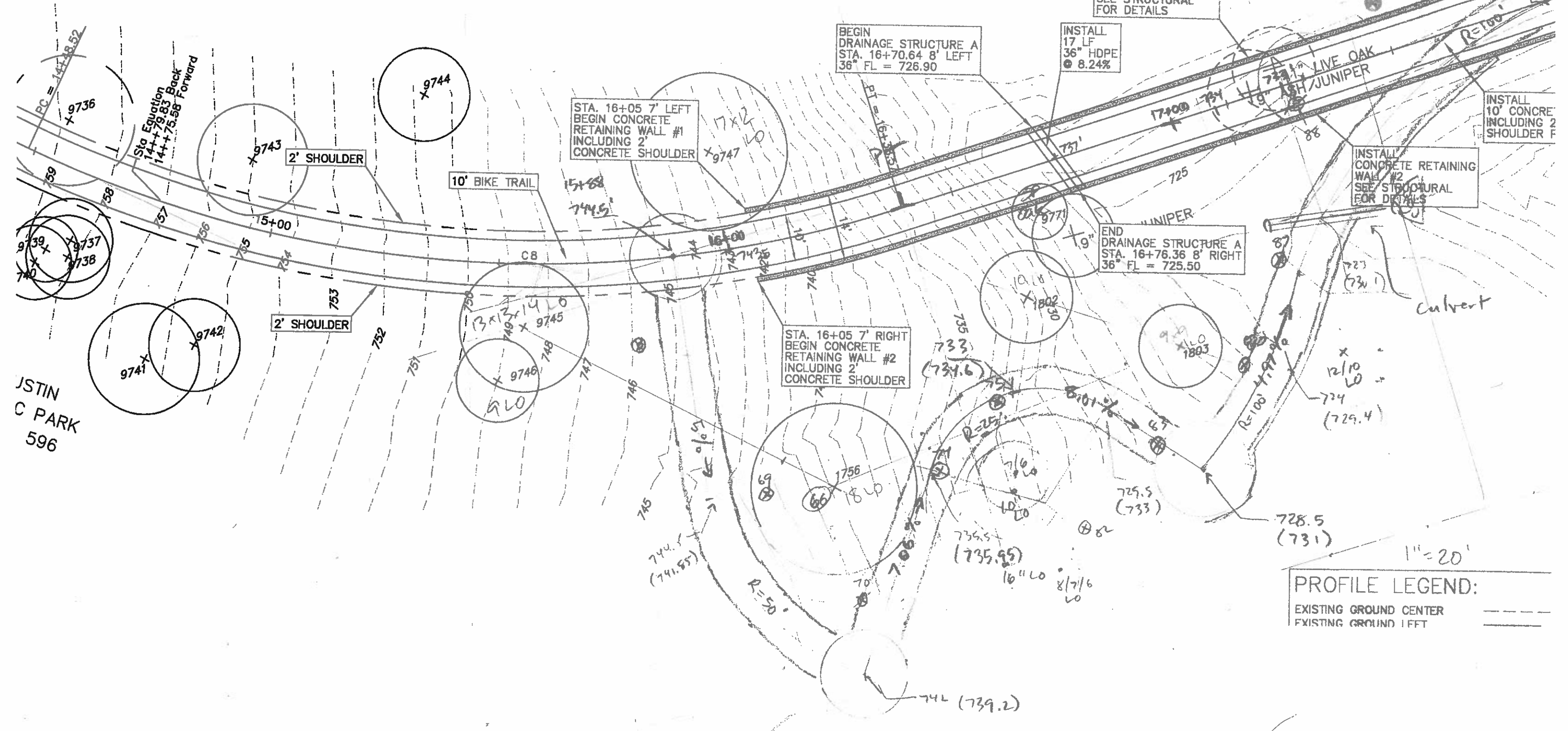

BORE B-2
 LOCATION
 STA. 17+50.00

INSTALL
 CONCRETE RETAINING
 WALL #1
 SEE STRUCTURAL
 FOR DETAILS

BEGIN
 DRAINAGE STRUCTURE A
 STA. 16+70.64 8' LEFT
 36" FL = 726.90

INSTALL
 17 LF
 36" HDPE
 @ 8.24%

STA. 16+05 7' LEFT
 BEGIN CONCRETE
 RETAINING WALL #1
 INCLUDING 2'
 CONCRETE SHOULDER

INSTALL
 10' CONCRETE
 INCLUDING 2'
 SHOULDER F

INSTALL
 CONCRETE RETAINING
 WALL #2
 SEE STRUCTURAL
 FOR DETAILS

END
 DRAINAGE STRUCTURE A
 STA. 16+76.36 8' RIGHT
 36" FL = 725.50

STA. 16+05 7' RIGHT
 BEGIN CONCRETE
 RETAINING WALL #2
 INCLUDING 2'
 CONCRETE SHOULDER

1" = 20'
PROFILE LEGEND:
 EXISTING GROUND CENTER
 EXISTING GROUND LEFT

X GPS waypt

71